

# FOR SALE

---

Ennismore Avenue,  
Chiswick, W4

---

Terraced House  
West London

---

£1,700,000 fh

---

5  4  2 



**horton  
andgarton**

SALES / LETTINGS / PROPERTY MANAGEMENT

hortonandgarton.co.uk | Sales 020 3989 6464 | Lettings 020 3989 5454  
161 Chiswick High Road, London, W4 2DT



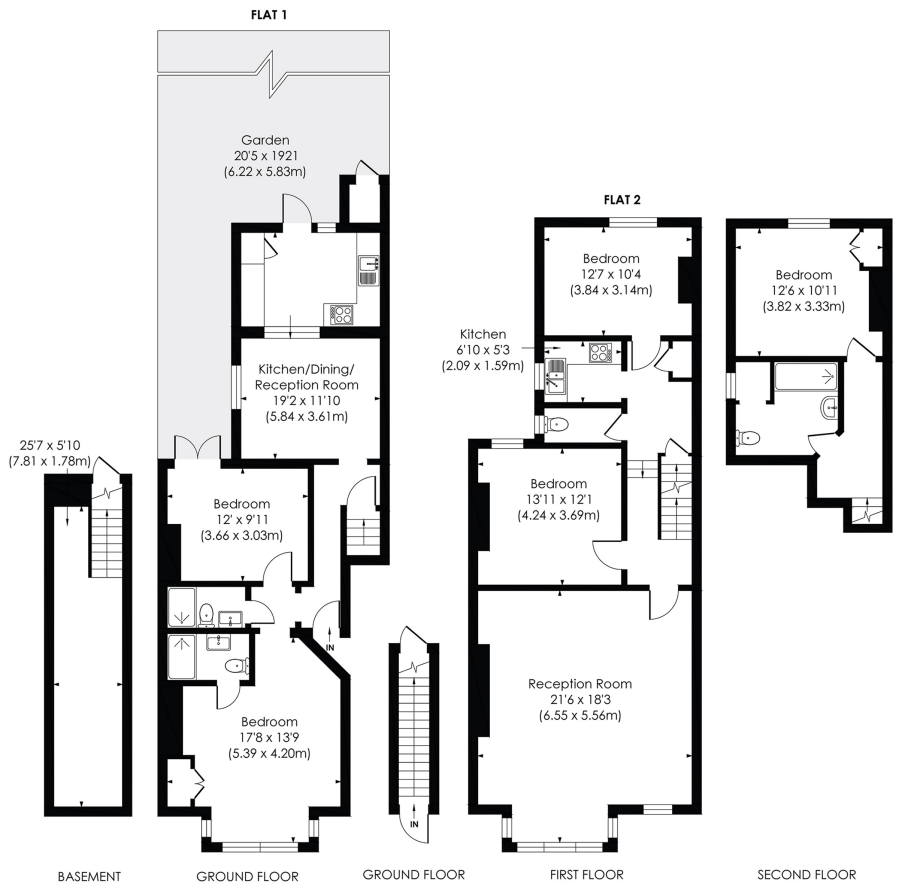

**ENNISMORE AVENUE, W4**

Approx. Gross Internal Floor Area  
**1991 Sq' / 184.93 SqM** (Including Basement)  
**1841 Sq' / 171.03 SqM** (Excluding Basement)



© Pixangle Property Marketing Ltd. info@pixangle.com Tel: 0208 870 2118

This floor plan has been prepared for the purpose of illustration only in accordance with the latest RICS code of measuring practice and is not to scale. All measurements and areas are approximate and whilst every effort has been made to ensure the accuracy of the plan contained here, no responsibility is taken for any error, omission or misstatement.



Freehold house arranged as two flats | 1841 Sq' – 171.03 SqM | EPC rating D | Five bedrooms - Four bathrooms | Chiswick | Westfacing private garden



hortonandgarton.co.uk  
 Sales 020 3989 6464  
 Lettings 020 3989 5454

161 Chiswick High Road, London, W4 2DT