

FOR SALE

Stile Hall Gardens,
Chiswick, W4

Flat
Chiswick

£600,000 sh of fh

2  1  1 



**horton
andgarton**

SALES / LETTINGS / PROPERTY MANAGEMENT

hortonandgarton.co.uk | Sales 020 3989 6464 | Lettings 020 3989 5454
161 Chiswick High Road, London, W4 2DT



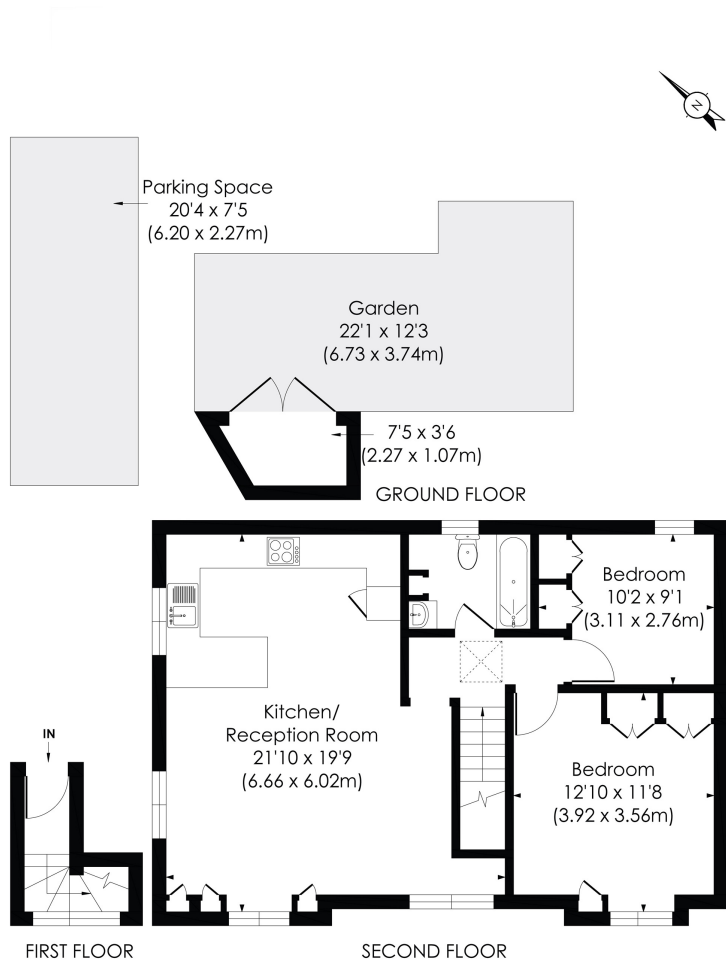

STILE HALL GARDENS, W4

Approx. Gross Internal Floor Area
738 Sq' / 68.58 SqM (Incl. RHH & External Storage)
716 Sq' / 66.48 SqM (Excl. RHH & External Storage)

© Pixangle Property Marketing Ltd. info@pixangle.com Tel: 0208 870 2118

This floor plan has been prepared for the purpose of illustration only in accordance with the latest RICS code of measuring practice and is not to scale. All measurements and areas are approximate and whilst every effort has been made to ensure the accuracy of the plan contained here, no responsibility is taken for any error, omission or misstatement.



Modern purpose built apartment | Two bedrooms - One bathroom | 716 Sq' - 66.48 SqM | EPC rating C | West facing garden and off street allocated parking | Chiswick



hortonandgarton.co.uk
 Sales 020 3989 6464
 Lettings 020 3989 5454

161 Chiswick High Road, London, W4 2DT