

FOR SALE

Aldensley Road,
Hammersmith, W6

Maisonette
Brackenbury Village

£875,000 lh

2  2  1 



**horton
andgarton**

SALES / LETTINGS / PROPERTY MANAGEMENT

hortonandgarton.co.uk | Sales 020 8819 0510 | Lettings 020 8819 0511
172 King Street, Hammersmith, W6 0QU



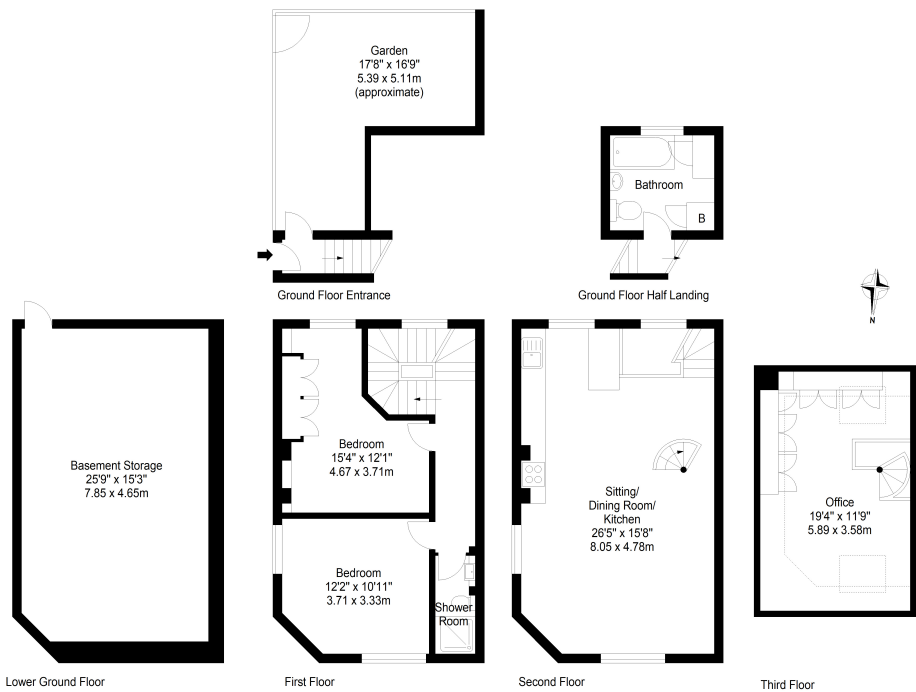

Flat
 Gross Internal Area 1157 sq ft - 107.49 sq m
 Cellar
 Gross Internal Area 386 sq ft - 35.86 sq m

Drawn from supplied plans.
 All measurements are approximate.
 This floor plan is for illustrative
 purposes only and is not to scale.
 © Horton and Garton Estate Agents 2026

**horton
and garton**



Split-level maisonette | Two bedrooms - Two bathrooms
 | 1157 Sq' – 107.49 SqM | No chain | EPC rating E |
 Brackenbury Village



hortonandgarton.co.uk
 Sales 020 8819 0510
 Lettings 020 8819 0511

172 King Street, Hammersmith, W6 0QU