

TO LET

Dorville Crescent,
Brackbury Village, W6

Flat
Brackbury Village

£2,000 pcm

1  1  1 



**horton
andgarton**

SALES / LETTINGS / PROPERTY MANAGEMENT

hortonandgarton.co.uk | Sales 020 8819 0510 | Lettings 020 8819 0511
172 King Street, Hammersmith, W6 0QU



horton andgarton

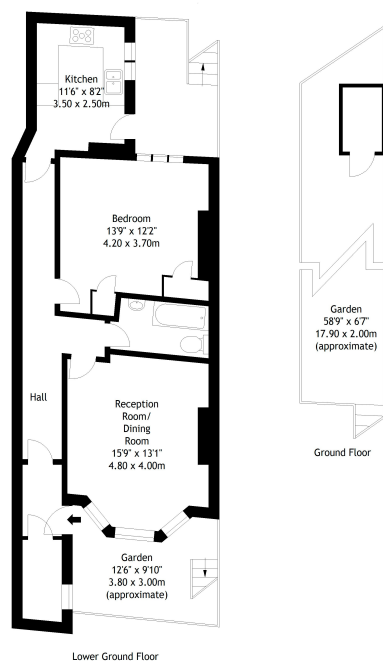

Darville Crescent, W6
Gross Internal Area 689 sq ft - 64.01 sq m

Drawn from supplied plans. All measurements are approximate.
This floor plan is for illustrative purposes only and is not to scale.
© Horton and Garton Estate Agents 2019



One double bedroom | Private garden | Bay fronted
reception room | Unfurnished | EPC rating C |
Brackenbury Village



hortonandgarton.co.uk
Sales 020 8819 0510
Lettings 020 8819 0511

172 King Street, Hammersmith, W6 0QU