

FOR SALE

Sutton Lane North,
Chiswick, W4

Terraced House
Chiswick

£1,400,000 fh

4  3  2 



**horton
andgarton**

SALES / LETTINGS / PROPERTY MANAGEMENT

hortonandgarton.co.uk | Sales 020 3989 6464 | Lettings 020 3989 5454
161 Chiswick High Road, London, W4 2DT



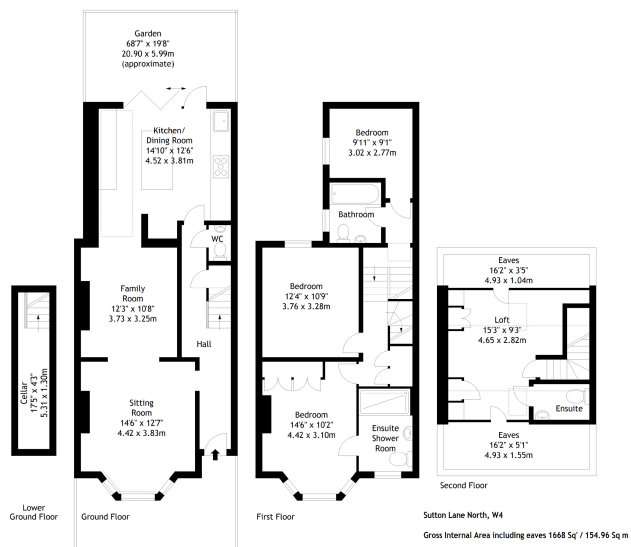

**horton
andgarton**



Sutton Lane North, W4
 Gross Internal Area including eaves 1668 Sq' / 154.96 Sq m
 Internal Area excluding Eaves 1531 Sq' / 142.23 Sq m
 Drawn from supplied plans.
 All measurements are approximate.
 This floor plan is for illustrative purposes only and is not to scale.
 © Horton and Garton Estate Agents 2026



Victorian family house | Four bedrooms - Three bathrooms | 1531 Sq' - 1142.23 SqM | Superb location | EPC rating C | Chiswick



hortonandgarton.co.uk
 Sales 020 3989 6464
 Lettings 020 3989 5454

161 Chiswick High Road, London, W4 2DT