

# FOR SALE

---

Bazalgette Court  
Hammersmith, W6

---

Flat  
Riverside

---

£700,000 lh

---

2  2  1 



**horton  
andgarton**

SALES / LETTINGS / PROPERTY MANAGEMENT

hortonandgarton.co.uk | Sales 020 8819 0510 | Lettings 020 8819 0511  
172 King Street, Hammersmith, W6 0QU



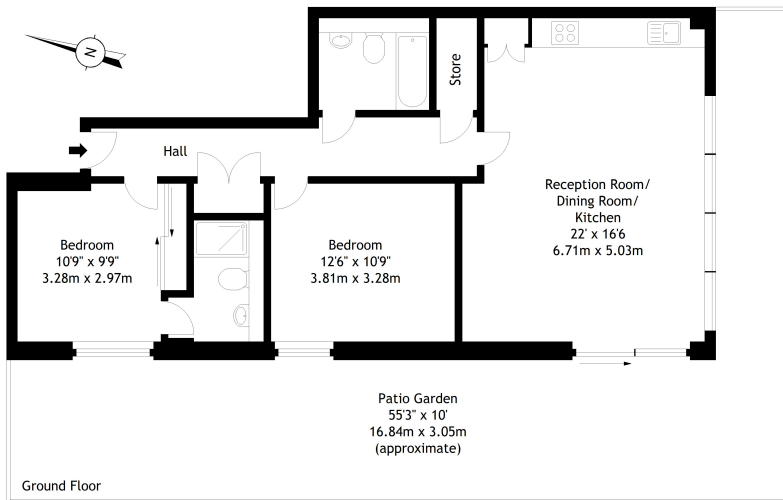

Parking Space # 37

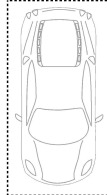

Ground-floor flat | Two bedrooms - Two bathrooms |  
884 Sq' - 82.08 SqM | Allocated off-street parking |  
EPC rating D | Riverside

**horton  
andgarton**

Bazalgette Court, W6  
Gross Internal Area 884 Sq' / 82.08 Sq m

Drawn from supplied plans.  
All measurements are approximate.  
This floor plan is for illustrative  
purposes only and is not to scale.  
© Horton and Garton Estate Agents 2026



hortonandgarton.co.uk  
Sales 020 8819 0510  
Lettings 020 8819 0511

172 King Street, Hammersmith, W6 0QU